



**WILANOW TOWN CENTER - Warsaw - Poland**

**→ PROGRAM**

Retail, restaurant, entertainment, office  
75 000 m<sup>2</sup> GLA

Urban new development

**→ CLIENT**

Cefic Polska / Simonvanhoe  
Contact : M. Antoine Mocachen : + 48 223 23 03 03

**→ DESIGN**

Collective

**→ OUR MISSION**

- Retail development strategy
- Project positioning & programming
- Master plan feasibility
- Merchandising plans
- Land control strategy
- Areas & volumes program: GLA, GBA...

**→ PROJECT STATUS**

Mission completed

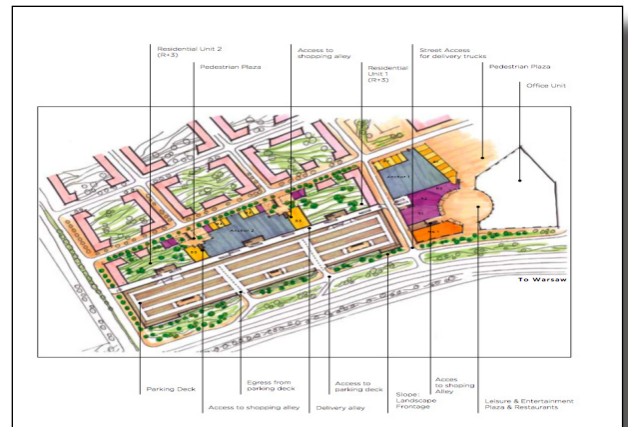

**Contact :**

Guillaume SADOUX  
Tel : + 32 (0) 473 12 75 60

info@birdseyeview.eu  
www.birdseyeview.eu

Bird's Eye View is member of

