



CLOCHE d'OR Shopping CENTER - Luxembourg

→ PROGRAM

Retail, restaurant, offices

Three-level retail development + 20 storey-high office tower
Urban neighborhood extension

→ CLIENT

Grossfeld PAP / Extensa / Bouwfond / Promobe
Contact : M. Kris Verhellen – Extensa : +32 2 237 08 27

→ DESIGN

Beng Architects - <http://www.beng.lu>

→ MISSION

- Project positioning & programming - Financial feasibility headlines
- Master plan feasibility
- Merchandising plans
- Infrastructures: parking, operations...
- Areas & volumes program: GLA, GBA...
- Core values & qualities to achieve
- Image & Identity precedents & targets
- Project governance
- Development milestone chain
- Design workshops & Arbitrage meeting
- Steering & arbitrage process

→ PROJECT STATUS

Under development

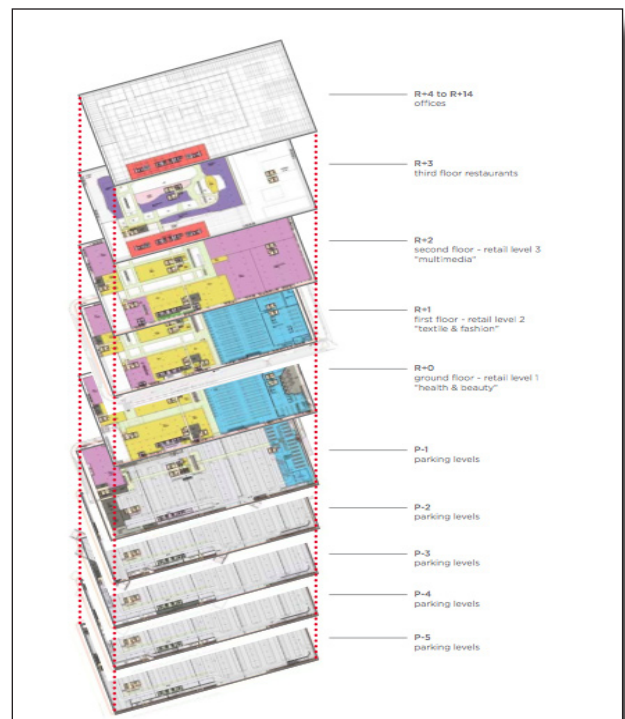
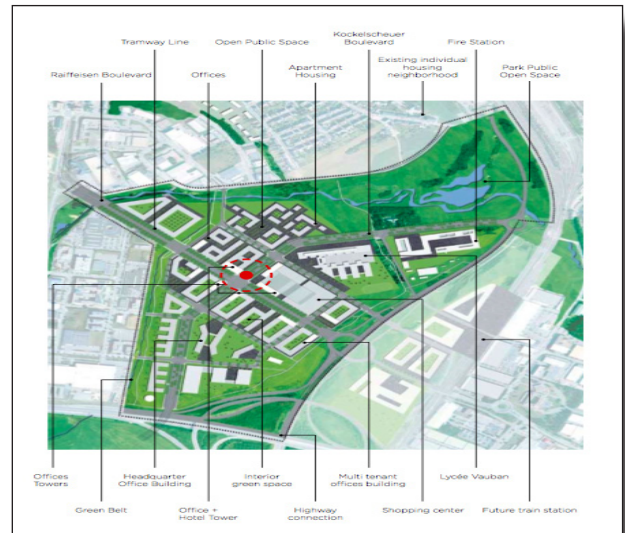

Contact :

Guillaume SADOUX
Tel : + 32 (0) 473 12 75 60

info@birdseyeview.eu
www.birdseyeview.eu

Bird's Eye View is member of

